



# ACCESSORY SAND FLAG MOUNT

FOR AEV 7000 SERIES LIGHT MOUNT

## NEW PRODUCT

Please visit [www.aev-conversions.com](http://www.aev-conversions.com) to view the most current installation guide for this product.

This is a new product and we want to make sure that you receive the latest and most accurate information based on customer feedback, product revisions, and/or model year updates. We value customer feedback, so we encourage you to contact our Technical Support department if you have any suggestions on how to make the installation of this product easier or if you have any questions regarding the installation of this product. AEV's Technical Support can be reached by email at [tech@aev-conversions.com](mailto:tech@aev-conversions.com) or by giving us a call at (248)-926-0256.

## PLEASE READ BEFORE YOU START

To guarantee a quality installation, we recommend reading these instructions thoroughly before beginning any work. These instructions assume a certain amount of mechanical ability and are not written nor intended for someone not familiar with auto repair.

INCLUDED PARTS	QTY	REQUIRED TOOLS
Accessory Dune Mount	1	Common Hand Tools
Hardware Pack	1	

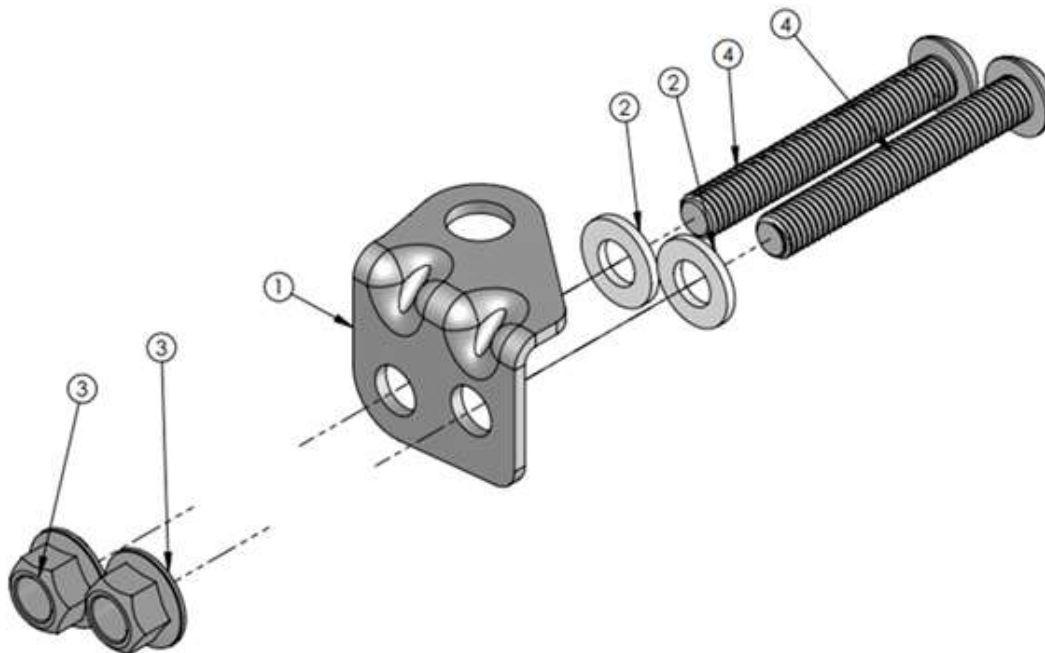

ITEM NO.	PartNo	DESCRIPTION	QTY.
1	AJLB1124AB	BRACKET, JL FRONT BUMPER, ACCESSORY SAND FLAG MOUNT	1
2	AEV98006AA	Washer, M10 - PS5873-Black	2
3	11546366	M10 X 1.5 HEX FLANGE LOCK NUT	2
4	AEV91199AA	Bolt, BHCS, M10-1.5x70 - 10.9	2

## I. VEHICLE PREPARATION

1. Remove QTY 2 M10 Thru Bolts from the passenger side Stamped Bracket (*fig. 1*):

Note: The 7000 Series Light Mount (38060002AB) is needed to attach the Accessory Sand Flag Mount to the bumper.

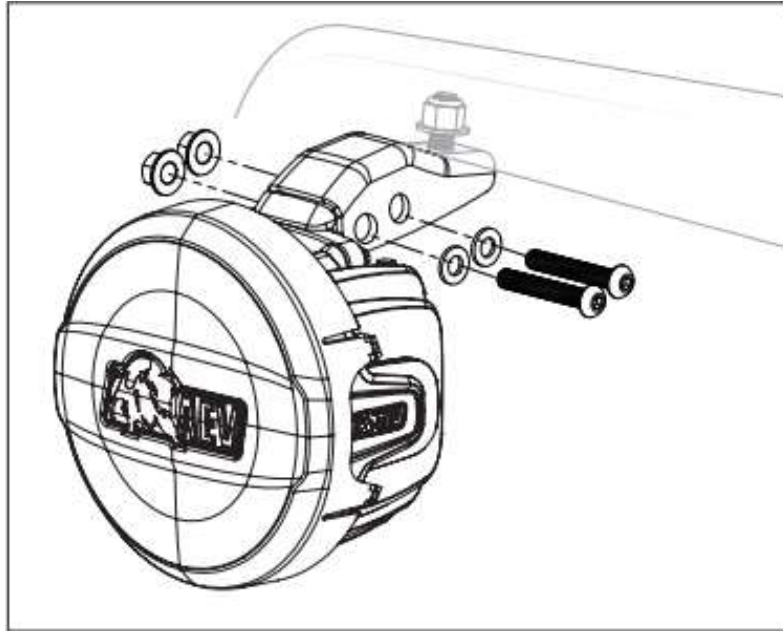

*Figure 1 - Optional 7000 Series Light Shown*

2. Insert bracket between the stamped bracket that is attached to the bumper tube using the bolts included in the kit. Assembly shown below (*fig. 2*).

Note: The button head bolts will need to be fed through the same side as the bracket for best fitment.

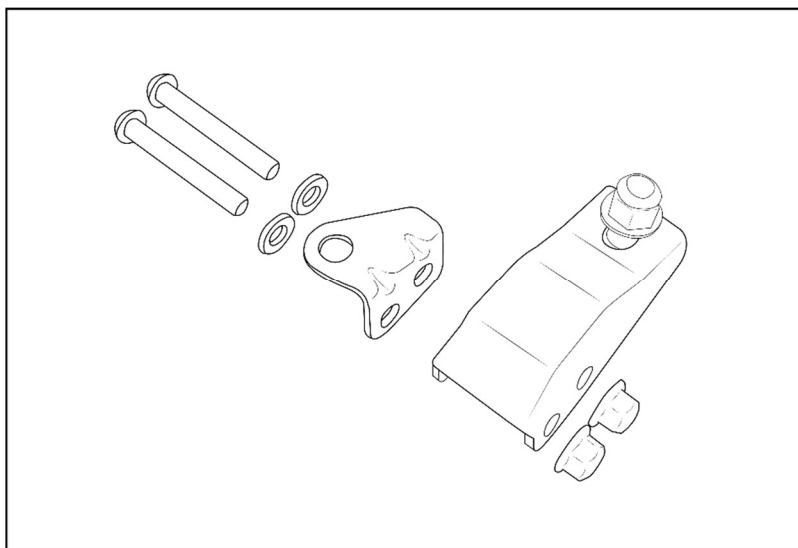

*Figure 2*