



# REAR HATCH LIGHT

## FOR JL WRANGLER

### PLEASE READ ENTIRELY BEFORE YOU START

To guarantee a quality installation, we recommend reading these instructions thoroughly before beginning any work. These instructions assume a certain amount of mechanical ability and are not written nor intended for someone not familiar with auto repair.

#### INCLUDED PARTS

30301088AA Harness, Hardtop Harness, Interior Light

30301089AA Harness, Liftgate Section, Interior Light

30301090AA Harness, Power Harness , Interior Light

30301091AA Harness, Baja Light with connector , Interior Light



1. Begin the installation by unplugging the rear wire harness (fig. 1).



*Figure 1*

2. Remove the side plastic covers, the trunk floor cover, and the driver's side floor runner, be aware that some components may require a wedge to separate the plastic or expose the fasteners that will need to be undone (fig. 2).



*Figure 2*



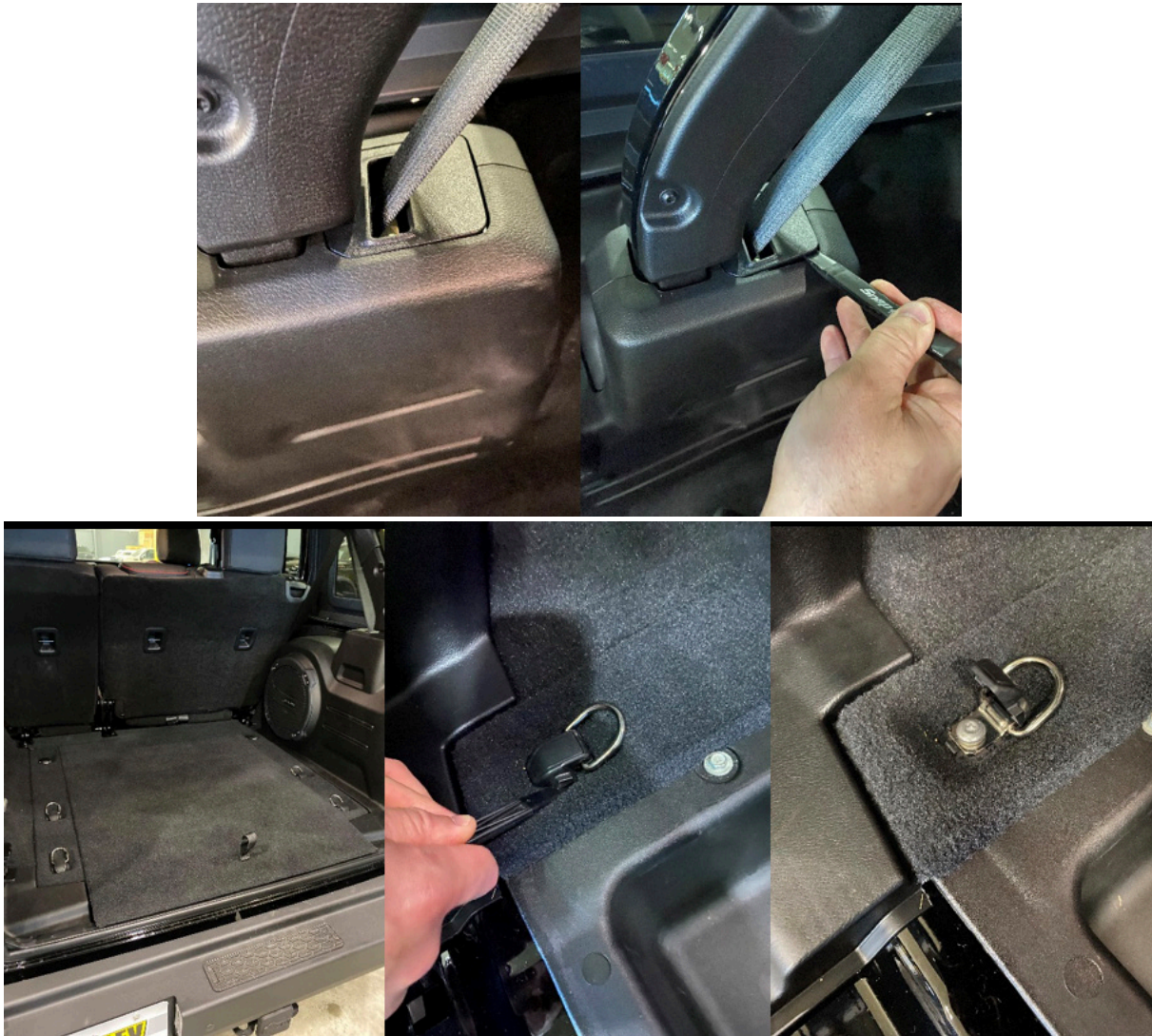

3. Remove the plastic liner of the driver's side and floor compartment (fig. 3).



Figure 3









4. Remove plastic cover that connects the motor wire harness to the hard top (fig. 4).



*Figure 4*

5. Unscrew wiper motor cap (fig. 5).



*Figure 5*



6. Remove the several plastic covers from the hatch, pay attention to the tabs that run along both sides that retain the part to the hatch (fig. 6).



Figure 6

7. Remove the plug on the driver's side of the glass, twist and pull for easy removal (fig. 7).



Figure 7





8. Remove the tape surrounding the wire harness (fig. 7).



9. Feed AEV30301088AA through the wire harness (fig. 8).



*Figure 8*

10. Mount the connector plug to onto the windshield wiper motor (fig. 9).

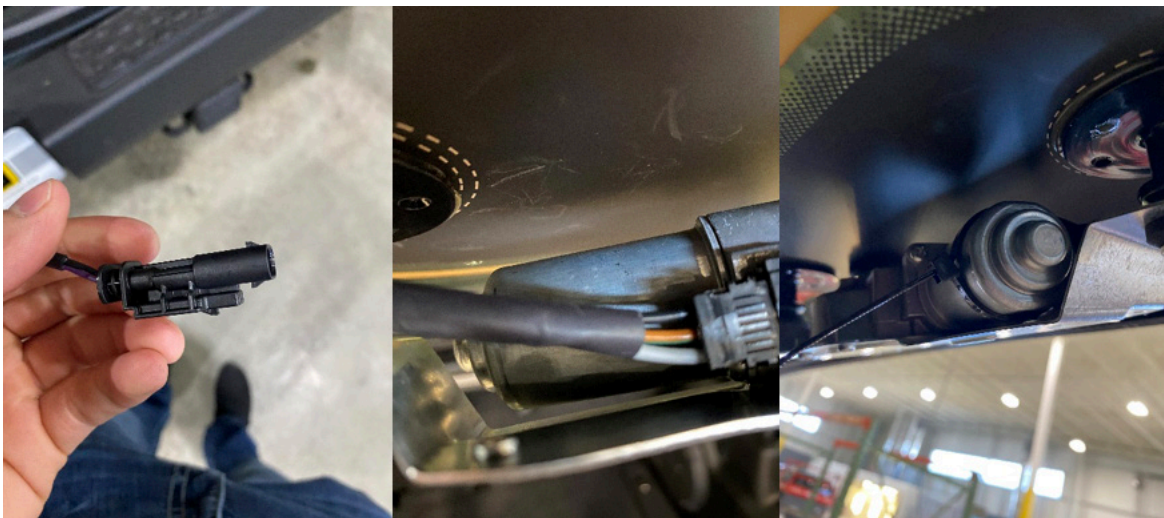

*Figure 9*





11. Mount the wire along the hinge, running the wire along the motor wire (fig. 10).



*Figure 10*

12. Reattach the previously removed plug. Attach the provided wire plug, lining the red location to the purple wire and black location to the black wire. Once both are connected push in the white safety block and retape the wire end of the wire harness. Attach AEV3030188AA to AEV3030189AA and feed the later through the hard top (fig. 11).

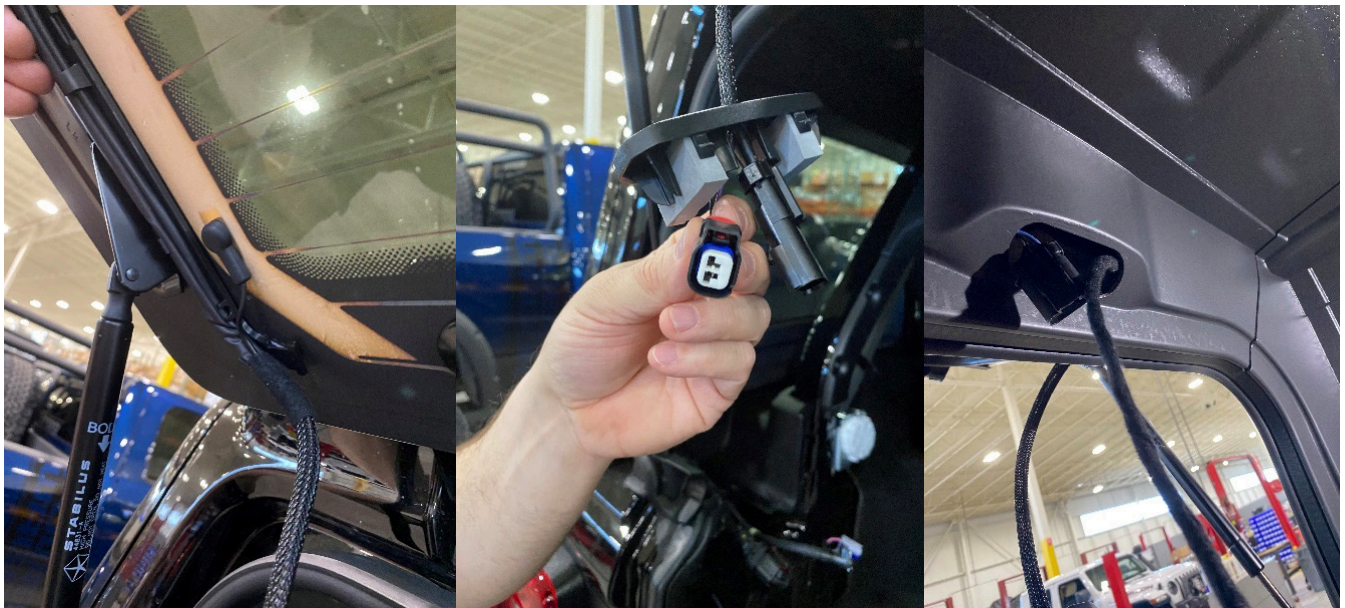

*Figure 11*





13. Remove both plugs from the plastic cover to allow for the addition of the new wire plug. Zip tie the washer hose and the new connector together then fit the three plugs back into the bezel. Feed the access wire into the hard top and reinstall the plastic cover over the exposed wiring (fig. 12).



Figure 12





14. Wire harness AEV30301090AA is to be wired through the following locations, zip tie the harness in these locations for best fitment (fig. 13).

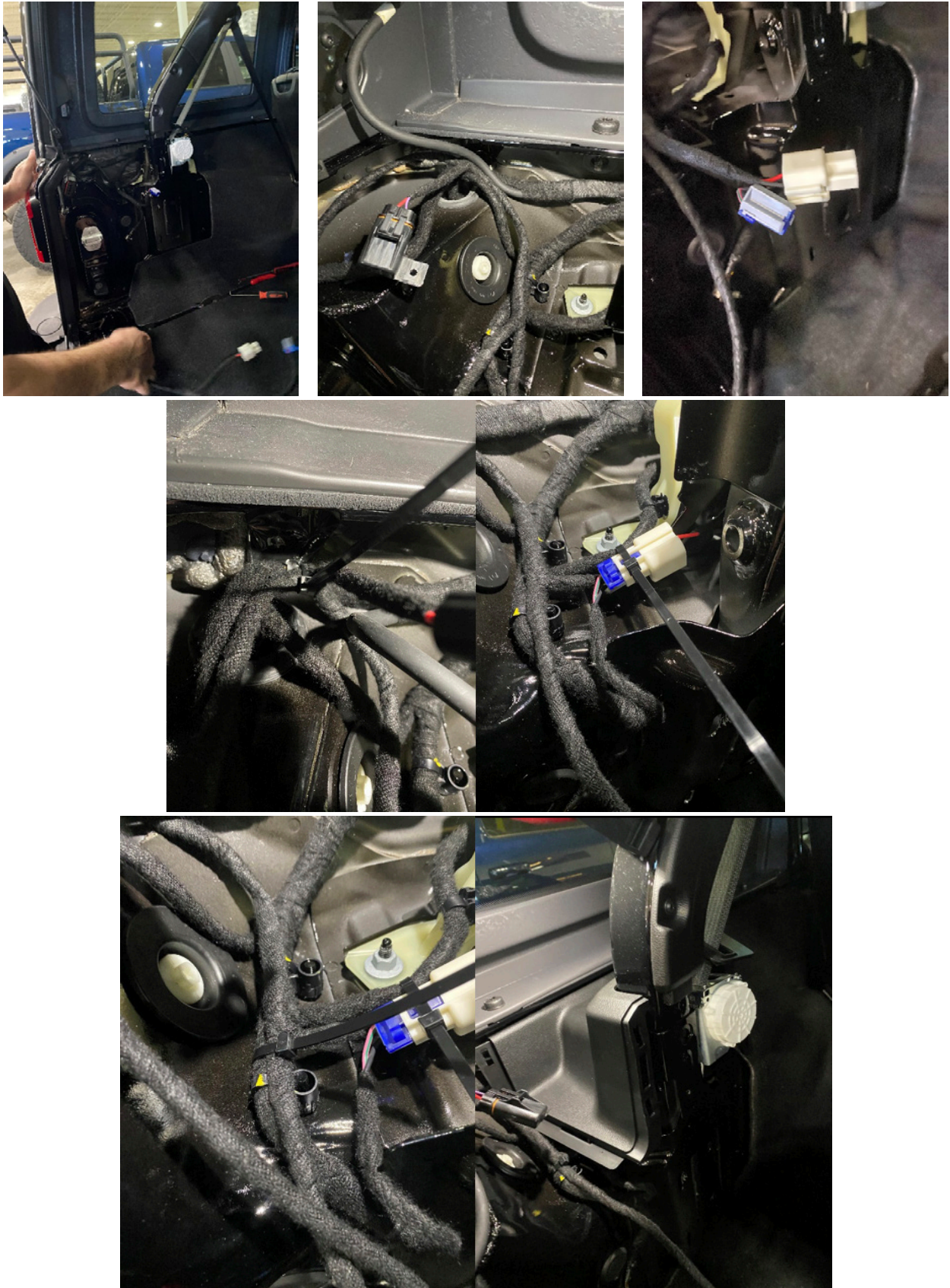

Figure 13





15. Drill out  $\frac{1}{4}$ " hole for the plastic bracket provided, make sure the hole isn't lined up with the interior ribbing. Attach said bracket with the provided hardware (fig. 14).



*Figure 14*

16. Begin attaching wires to their corresponding plugs and reassemble the interior of the vehicle (fig. 15).



*Figure 15*





17. Drill out the two fastener and wire access holes into the previously removed wiper motor cover, fasten the provided light to the cover, attach the wires and reinstall cover over the motor (fig. 16).



Figure 16