



HIGH PERFORMANCE STEERING DAMPER

2018+ WRANGLER & GLADIATOR

PLEASE READ ENTIRELY BEFORE YOU START

To guarantee a quality installation, we recommend reading these instructions thoroughly before beginning any work. These instructions assume a certain amount of mechanical ability and are not written nor intended for someone not familiar with auto repair.



1. Place the vehicle on flat, dry ground or on a hoist and chock the wheels for safety.
2. Remove the factory steering stabilizer by loosening and removing the bolt and flag nut at the axle end, then the nut and carriage bolt at the tie rod (fig. 1).

NOTE: Some newer vehicles are equipped with a special carriage bolt with a longer square shank than normal. These will not work with the AEV steering stabilizer. If equipped with that bolt, discard it and use the AEV-provided nut and bolt (fig. 2).

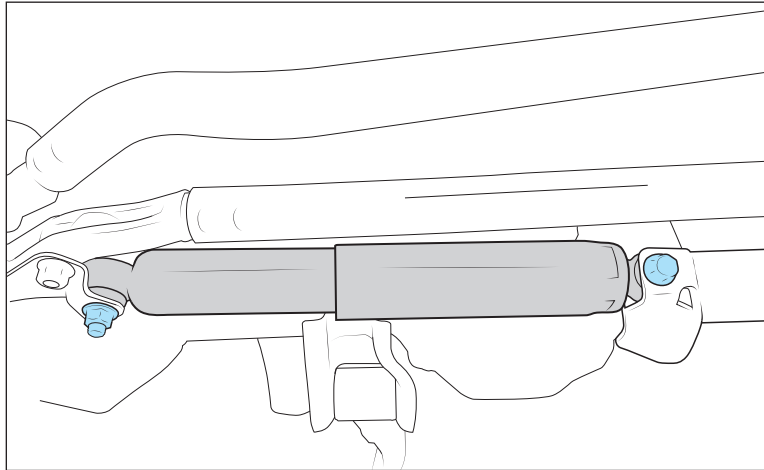

Figure 1

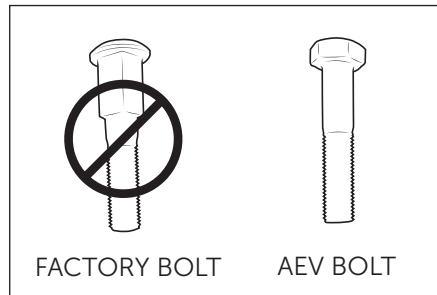

Figure 2

3. Install body side of the AEV steering damper into the tie rod brackets (fig. 3). Install factory carriage bolt (if equipped with short square that doesn't protrude past the bracket) or AEV hex bolt from the top and then loosely install the flange nut from the bottom. **The factory carriage bolt must use the factory nut, the AEV bolt must use the AEV nut. They have a different thread pitch that is not interchangeable.**

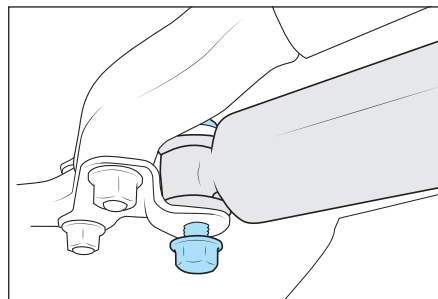

Figure 3



4. Compress the damper by hand until it can go past the axle bracket (fig. 4). Have the factory bolt ready to slip into place as the damper extends. The valving is very stiff, so it will take quite a bit of force to compress it. It may help to use a socket extension or long screwdriver through the bushing in order to push with both hands. Once compressed, slip it into place in the axle bracket, then as it extends back into position insert the factory bolt through the bracket and bushing. Install the flag nut on the back side (fig. 5).

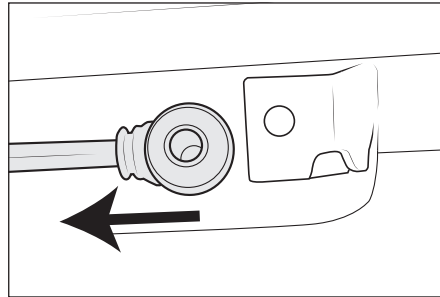

Figure 4

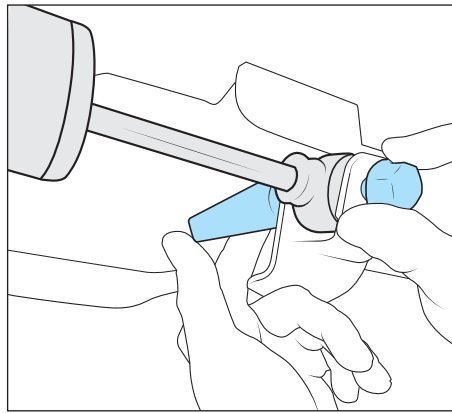

Figure 5

5. Torque the nut/bolt at the tie rod bracket to 52 ft-lb and the bolt at the axle to 59 ft-lb.