

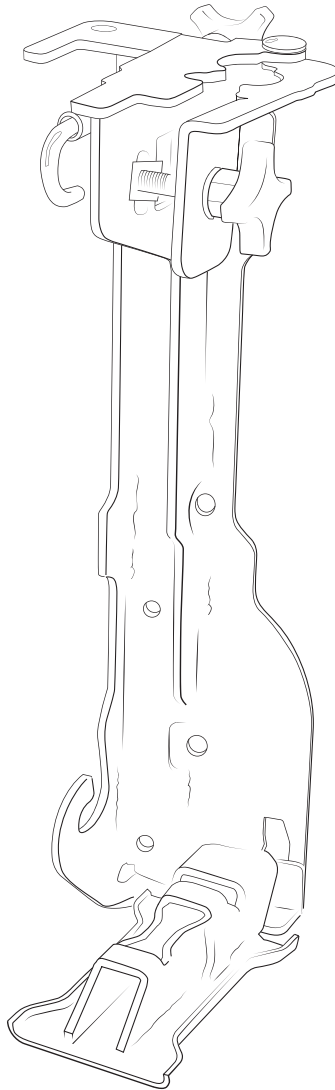

////////////////////////////////////

HI-LIFT/PULL-PAL MOUNT



10305017AA
Last Updated: 1/13/12

INSTALLATION GUIDE



PLEASE READ BEFORE YOU START

TO GUARANTEE A QUALITY INSTALLATION, WE RECOMMEND READING THESE INSTRUCTIONS THOROUGHLY BEFORE BEGINNING ANY WORK. THESE INSTRUCTIONS ASSUME A CERTAIN AMOUNT OF MECHANICAL ABILITY AND ARE NOT WRITTEN NOR INTENDED FOR SOMEONE NOT FAMILIAR WITH AUTO REPAIR.

INCLUDED PARTS	QTY	REQUIRED TOOLS
Accessory Mount Frame	1	Wrenches—3/8" and 5/16"
Hi-Lift Bracket Arm	1	Power drill
Hi-Lift Footplate	1	Drill bits—1/8" and 5/16"
5/16" U-bolt	2	Center punch
5/16"-18 Lock Nut	4	
3/8"-16 Carriage Bolt	1	
3/8"-16 Lock Nut	1	
3/8" Flat Washer	2	
Pull-Pal Roller	1	
Stud Knob 3/8"-16 x 2 1/2"	1	
J-Hook Anchor Bolt 5/16"-18 x 8"	1	
Nut Knob 5/15"-18	1	
5/16" Flat Washer	1	
1/4" Flat Washer	1	
U-Nut 3/8"-16	1	

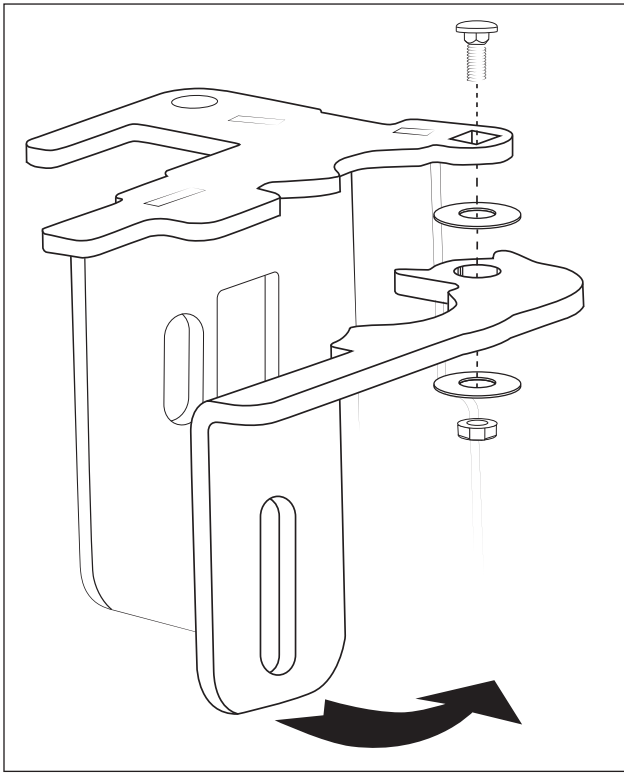

1.

Attach Hi-Lift jack bracket arm to Hi-Lift/Pull-Pal mount frame using 3/8" Carriage Bolt as shown

DO NOT OVERTIGHTEN—Bracket should swing easily.

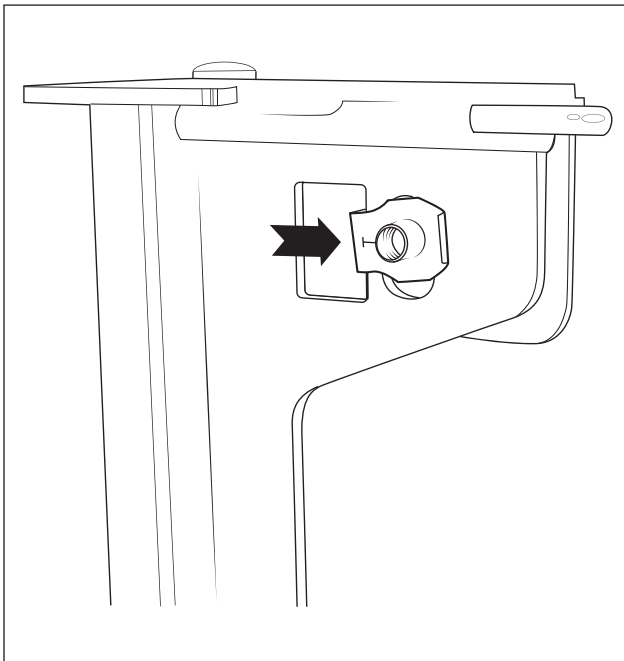

2.

Slide U-nut onto Hi-Lift/Pull-Pal mount frame.

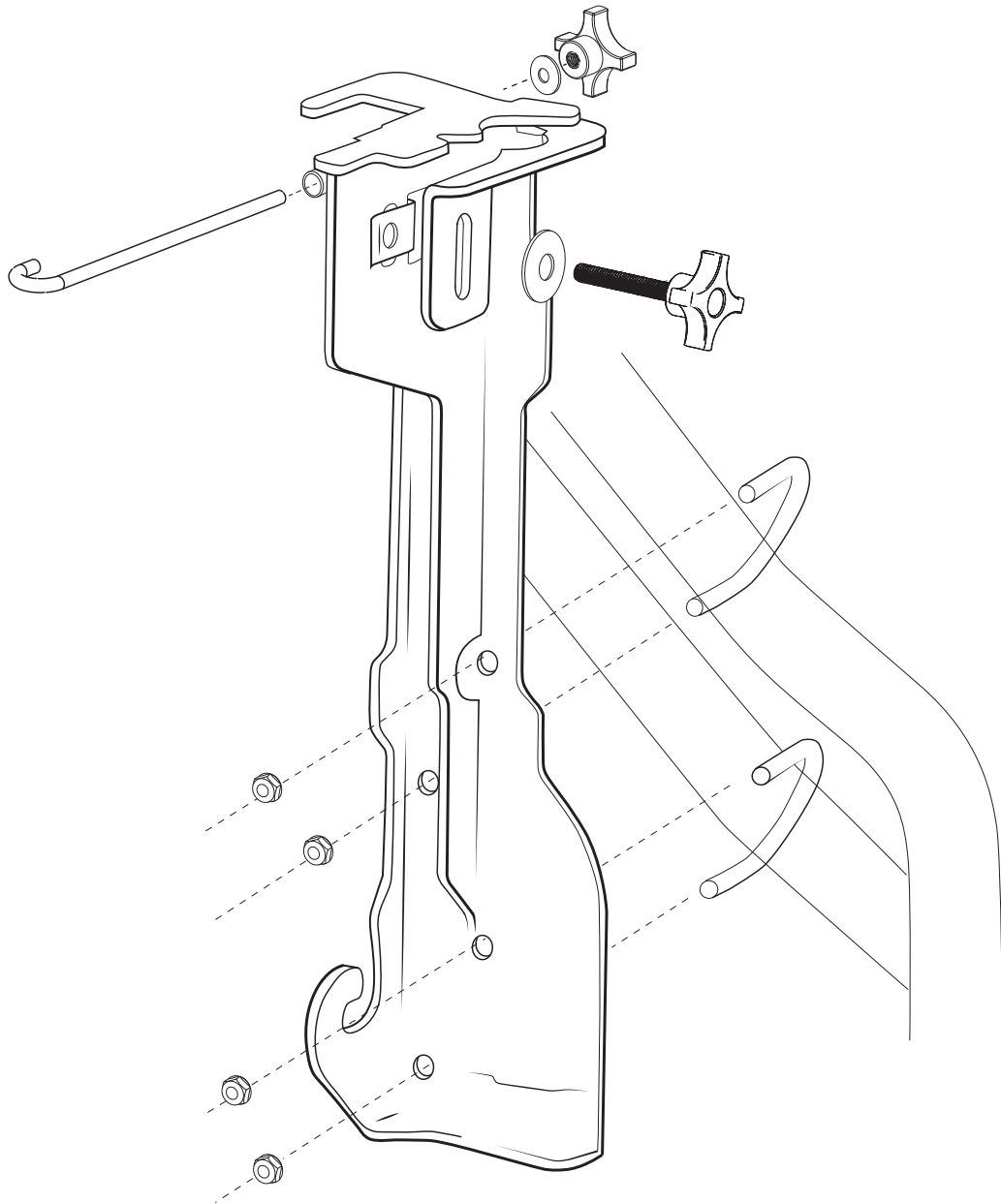

3.

Attach Hi-Lift/Pull-Pal mount to tire carrier tubing with U-bolts (2) and lock nuts (4). Make sure the mount is straight/vertical as the nuts are tightened.

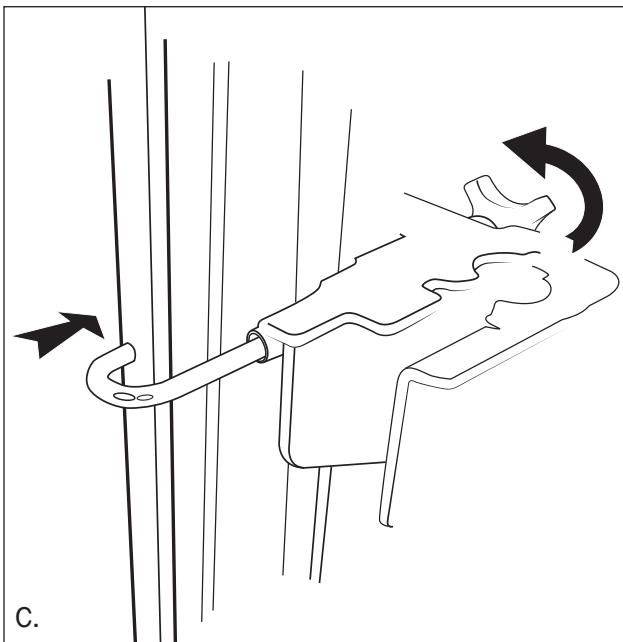
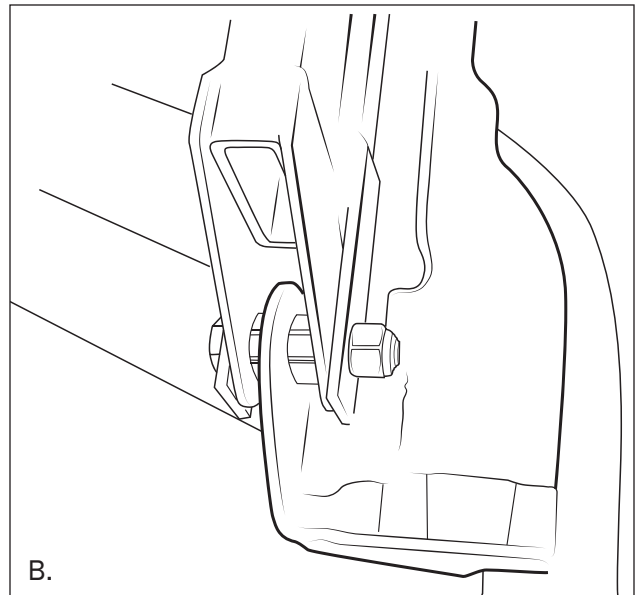
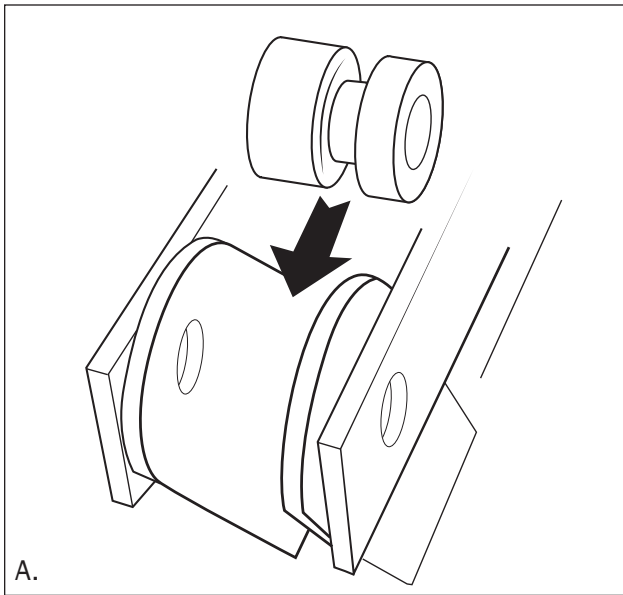

4.

- A. Remove hinge bolt from your Pull-Pal. Insert AEV Pull-Pal roller, making sure the groove is to the right as shown, and replace bolt. **DO NOT OVERTIGHTEN.**
- B. Lift pull-pal onto Hi-Lift/Pull-Pal mount, setting roller into the hook on the accessory mount frame.
- C. Use locking J-bar to mark location for drilling on your Pull-Pal. Punch the center location then drill a 1/8 in pilot hole. Drill or ream out to 5/16 in. Insert J-bar into hole and tighten nut knob to secure.

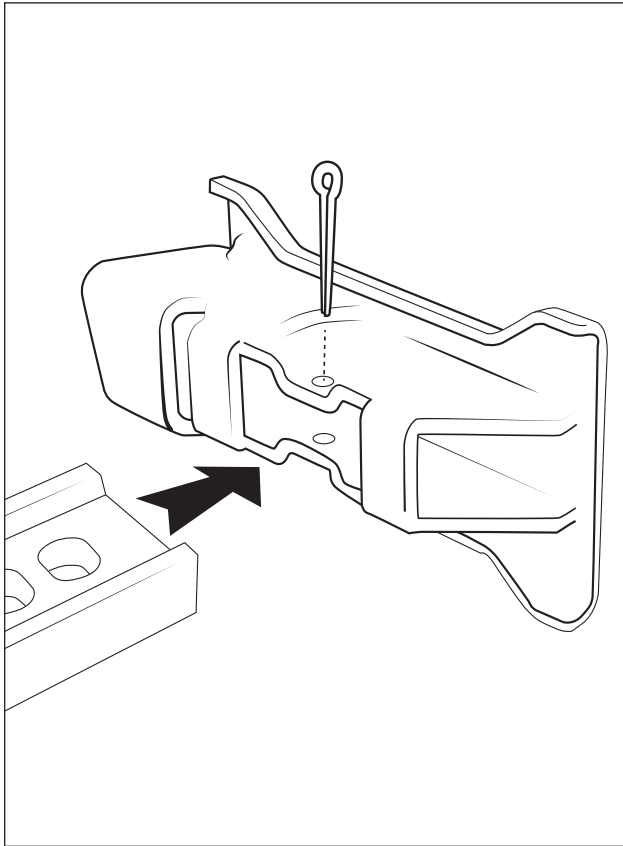

5.

Remove cotter pin from the Hi-Lift footplate.

Remove factory Hi-Lift footplate and replace with AEV Hi-Lift/Pull-Pal mount Hi-Lift footplate.

Replace cotter pin.

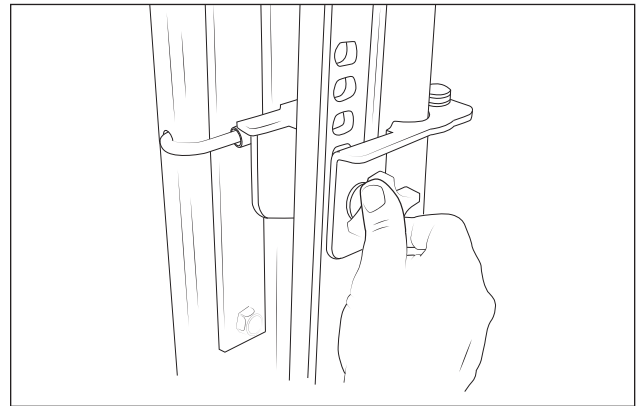
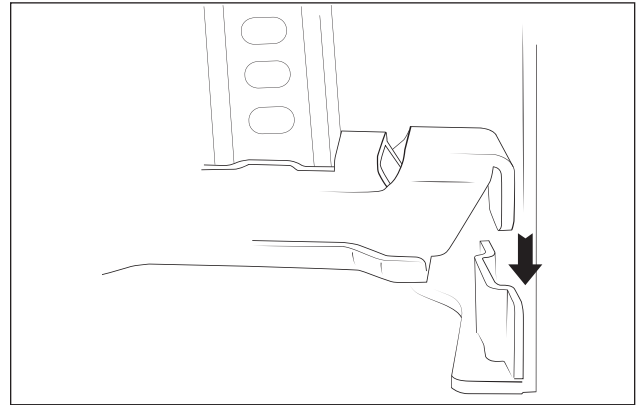

6.

Lift jack onto accessort mount inserting the footplate's tab into the frame's slot.

Remove Hi-Lift locking stud knob (assembled in step 3B), slide through hole on jack column and tighten securely into U-nut.

Slide Pull-Pal locking J-bar through Hi-Lift/Pull-Pal mount frame and secure with washer and nut knob (see illustration on pg. 3).

Slide stud knob through washer and Hi-Lift bracket arm and hand tighten into U-nut (see illustration on pg. 3).

IMPORTANT!

For JK Wranglers 2011 and newer YOU MUST close the rear window before shutting the tailgate. Failure to do so will cause the Hi-Lift Jack and Pull-Pal to break the rear window.